

하이코

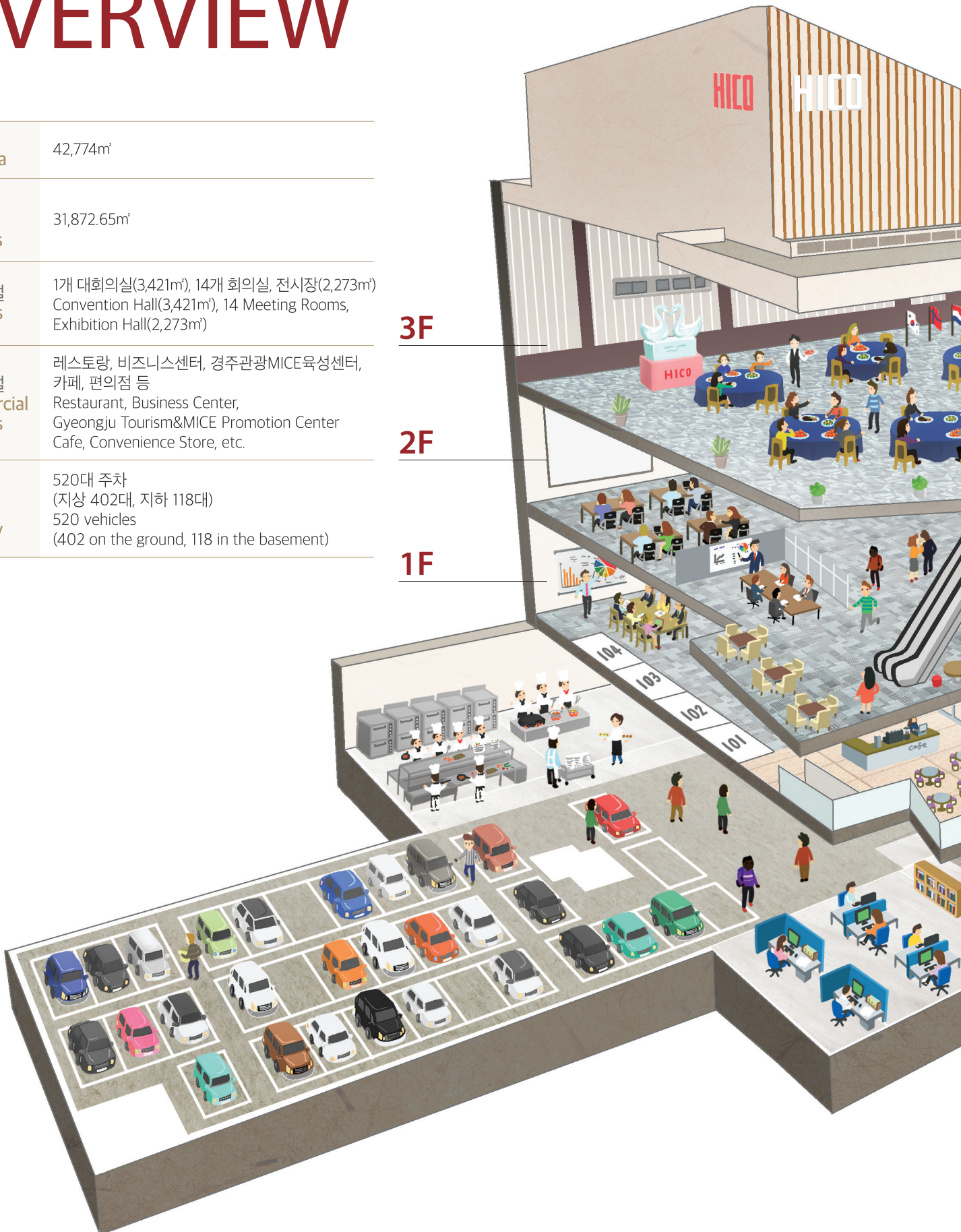

HICO OVERVIEW

부지면적 Site Area	42,774m ²
연면적 Total Grounds	31,872.65m ²
주요 시설 Facilities	1개 대회의실(3,421m ²), 14개 회의실, 전시장(2,273m ²) Convention Hall(3,421m ²), 14 Meeting Rooms, Exhibition Hall(2,273m ²)
부대 시설 Commercial Facilities	레스토랑, 비즈니스센터, 경주관광MICE육성센터, 카페, 편의점 등 Restaurant, Business Center, Gyeongju Tourism&MICE Promotion Center Cafe, Convenience Store, etc.
주차규모 Parking Capacity	520대 주차 (지상 402대, 지하 118대) 520 vehicles (402 on the ground, 118 in the basement)



“화백은 토론으로 지혜와 합의를 구하는
오늘날의 민주주의 발상이 된 신라의 제도입니다.”

Hwabaek is a Silla's deliberative body, the Council of Nobles,
which laid the foundation for democracy by seeking wisdom and compromise
through discussions and debates.



FLOOR PLANS OVERVIEW

4F 레스토랑 Restaurant

3F 대회의실 Convention Hall

2F 회의실, 귀빈회의실 Meeting Rooms, VIP Meeting Rooms

1F 회의실, 전시장, 야외전시장 Meeting Rooms, Exhibition Hall, Outdoor Exhibition Space

B1 HICO 플라자, 지하 주차장 HICO Plaza, Underground Parking Lot

1F

MEETING ROOMS / EXHIBITION HALL / OUTDOOR EXHIBITION SPACE

회의실 / 전시장 / 야외전시장



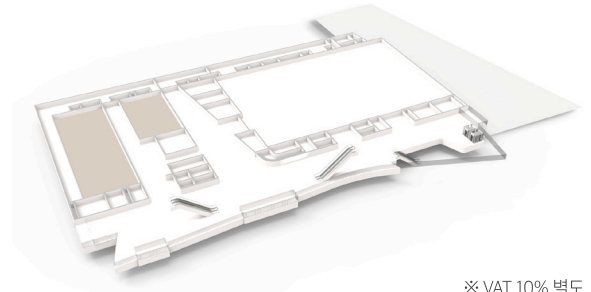

회의실 Meeting Rooms

※ VAT 10% 별도

구분 Facility	면적 Area (m ²)	가로x세로x높이 LxWxH (m)			극장식 Theater	강의식 Class- room	연회식 Banquet	임대료(원) Rental Rates (Unit: KRW, VAT not included)					
								09:00 -12:00	13:00 -17:00	18:00 -21:00	09:00 -17:00	13:00 -21:00	09:00 -21:00
								오전 Morning	오후 Afternoon	저녁 Evening	전일 Full Day	반일 Half Day	종일(1일) All Day
101, 102, 103, 104	125	13.9	9.6	4.5	120	72	60	332,000	398,000	299,000	664,000	730,000	996,000
101+102, 103+104	250	13.9	19.2	4.5	240	144	120	664,000	796,000	598,000	1,328,000	1,460,000	1,992,000
102+103+104	375	13.9	28.8	4.5	360	216	180	996,000	1,194,000	897,000	1,992,000	2,190,000	2,988,000
101+102+103+104	500	13.9	38.4	4.5	480	288	240	1,328,000	1,592,000	1,196,000	2,656,000	2,920,000	3,984,000
105, 106	115	12.4	10.1	4.5	110	66	50	298,000	357,000	268,000	595,000	655,000	893,000
105+106	230	12.4	20.2	4.5	220	132	100	596,000	714,000	536,000	1,190,000	1,310,000	1,786,000

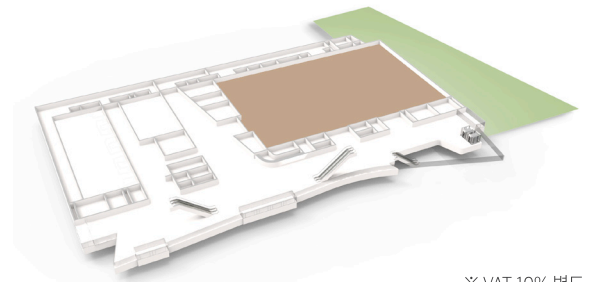

전시장 Exhibition Hall

※ VAT 10% 별도

구분 Facility	면적 Area (m ²)	가로x세로x높이 LxWxH (m)			규모 3x3m booth	화물출입구높이 Height of Cargo Entrance	바닥하중 Floor Load	트렌치 Floor Trench	바닥마감 Floor Finish	임대료 (원) Rental Rates (Unit: KRW, VAT not included)
Hall1, Hall2	1,136	29.5	38.4	8	50	4.2m	3 ton/m ²	전기, 급배수, 압축공기, 전화, 인터넷 Electricity, Water/Drainage, Compressed Air, Telephone, Internet	콘크리트 에폭시 Concrete Epoxy	1,704,000
Hall1+Hall2	2,273	59.2	38.4	8	115					3,409,500
야외전시장 Outdoor Exhibition Space	2,400	30	80	-	120	-	-	잔디 및 보도블록 Grass & Precast Pavers	2,400,000	



2F

MEETING ROOMS / VIP MEETING ROOMS

회의실 /贵宾회의실

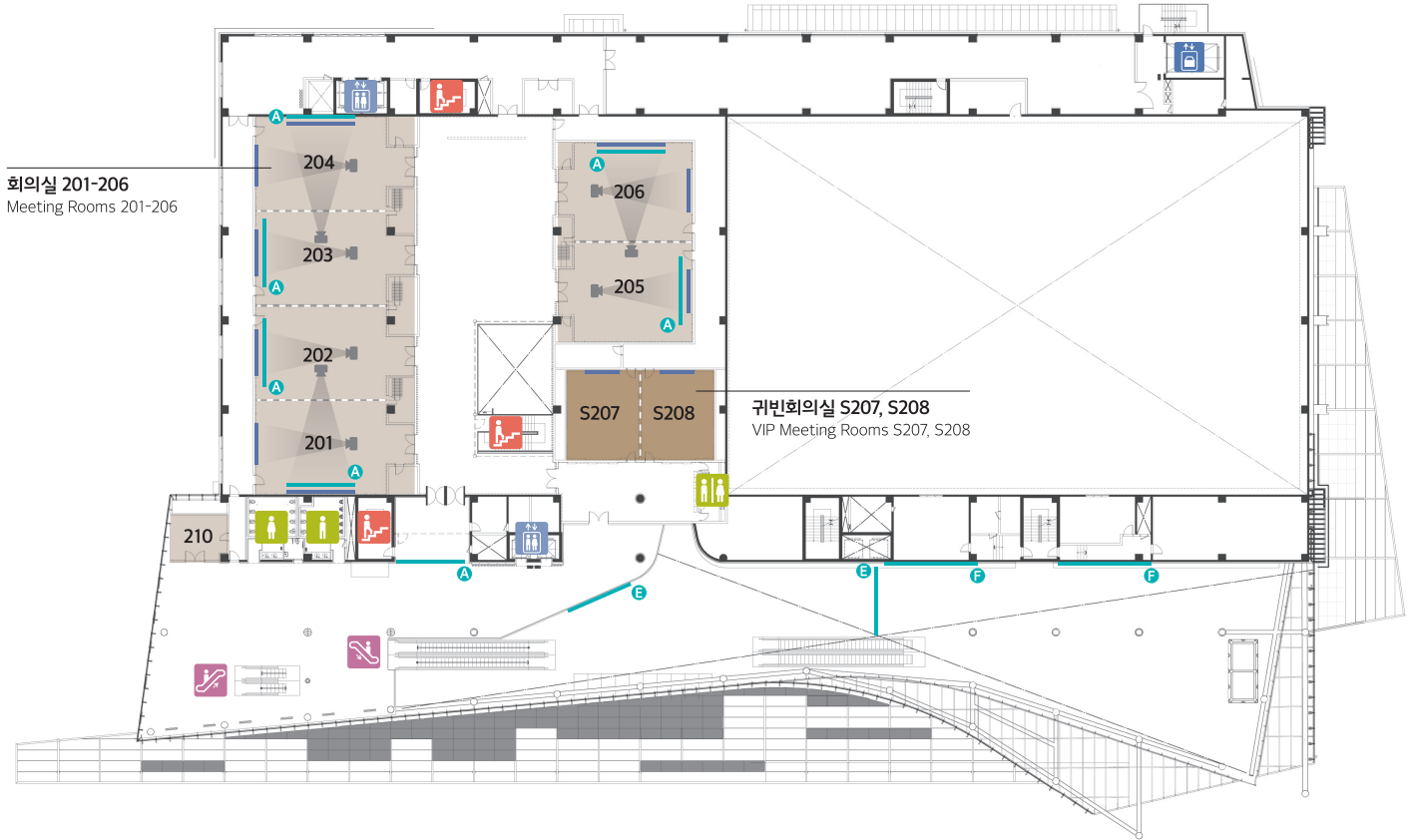

회의실 201-206
Meeting Rooms 201-206

贵宾회의실 S207, S208
VIP Meeting Rooms S207, S208

회의실 빔프로젝터/스크린
Beam Projector/Screen in the Meeting Rooms

- Main 10,000ANSI/300"
- Sub 10,000ANSI/200"

贵宾회의실 스크린
Screen in the VIP Meeting Rooms

- 150"

현수막 바텐
Banner Batten

- A : 5.7m(L)
- E : 5.7m(L)
- F : 7.5m(L)

계단 stairs

승강기 elevator

화물용 엘리베이터 freight elevator

에스컬레이터 escalator

화장실 restroom

스크린 screen

현수막 바텐 banner batten

빔프로젝터 beam projector

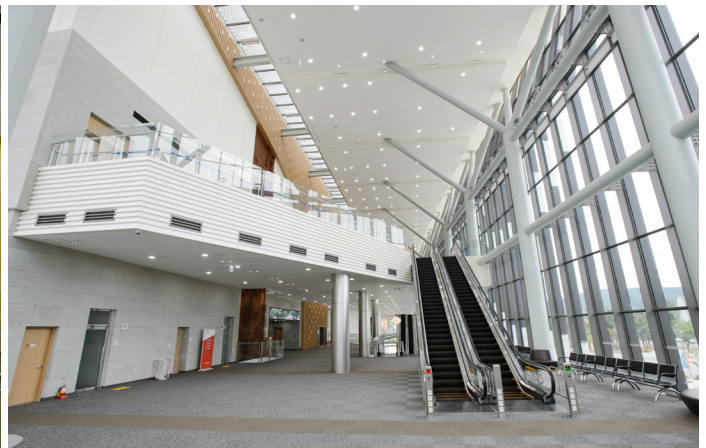

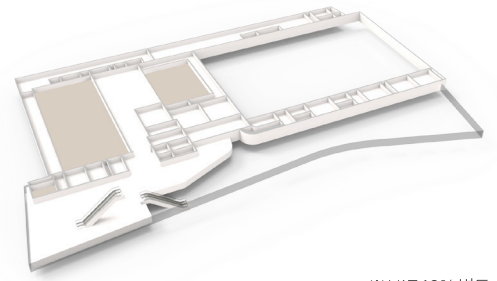

회의실 Meeting Rooms

※ VAT 10% 별도

구분 Facility	면적 Area (m)	가로x세로x높이 LxWxH (m)			극장식 Theater	강의식 Class- room	연회식 Banquet	임대료(원) Rental Rates (Unit: KRW, VAT not included)					
								09:00 -12:00	13:00 -17:00	18:00 -21:00	09:00 -17:00	13:00 -21:00	09:00 -21:00
								오전 Morning	오후 Afternoon	저녁 Evening	전일 Full Day	반일 Half Day	종일(1일) All Day
201, 202, 203, 204	141	16.3	9.6	4.5	130	78	70	354,000	424,000	318,000	707,000	778,000	1,060,000
201+202, 203+204	282	16.3	19.2	4.5	260	156	140	707,000	848,000	636,000	1,414,000	1,555,000	2,120,000
202+203+204	423	16.3	28.8	4.5	390	234	210	1,062,000	1,272,000	954,000	2,121,000	2,334,000	3,180,000
201+202+203+204	564	16.3	38.4	4.5	520	312	280	1,414,000	1,696,000	1,272,000	2,828,000	3,110,000	4,240,000
205, 206	131	13.8	10.2	4.5	120	72	60	332,000	398,000	299,000	664,000	730,000	996,000
205+206	262	13.8	20.4	4.5	240	144	120	664,000	796,000	598,000	1,328,000	1,460,000	1,992,000
210	28	5.8	4.9	2.5	25	18	-	70,000	84,000	63,000	140,000	154,000	210,000

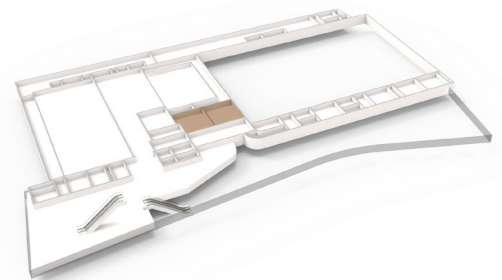

귀빈회의실 VIP Meeting Rooms

※ VAT 10% 별도

구분 Facility	면적 Area (m)	가로x세로x높이 LxWxH (m)			수용인원 Capacity	임대료(원) Rental Rates (Unit: KRW, VAT not included)					
						09:00 -12:00	13:00 -17:00	18:00 -21:00	09:00 -17:00	13:00 -21:00	09:00 -21:00
						오전 Morning	오후 Afternoon	저녁 Evening	전일 Full Day	반일 Half Day	종일(1일) All Day
S207	80	8.7	9.3	3.9	14명	202,000	243,000	182,000	405,000	445,000	607,000
S208	80	8.7	9.3	3.9	12명	202,000	243,000	182,000	405,000	445,000	607,000



3F

CONVENTION HALL 대회의실

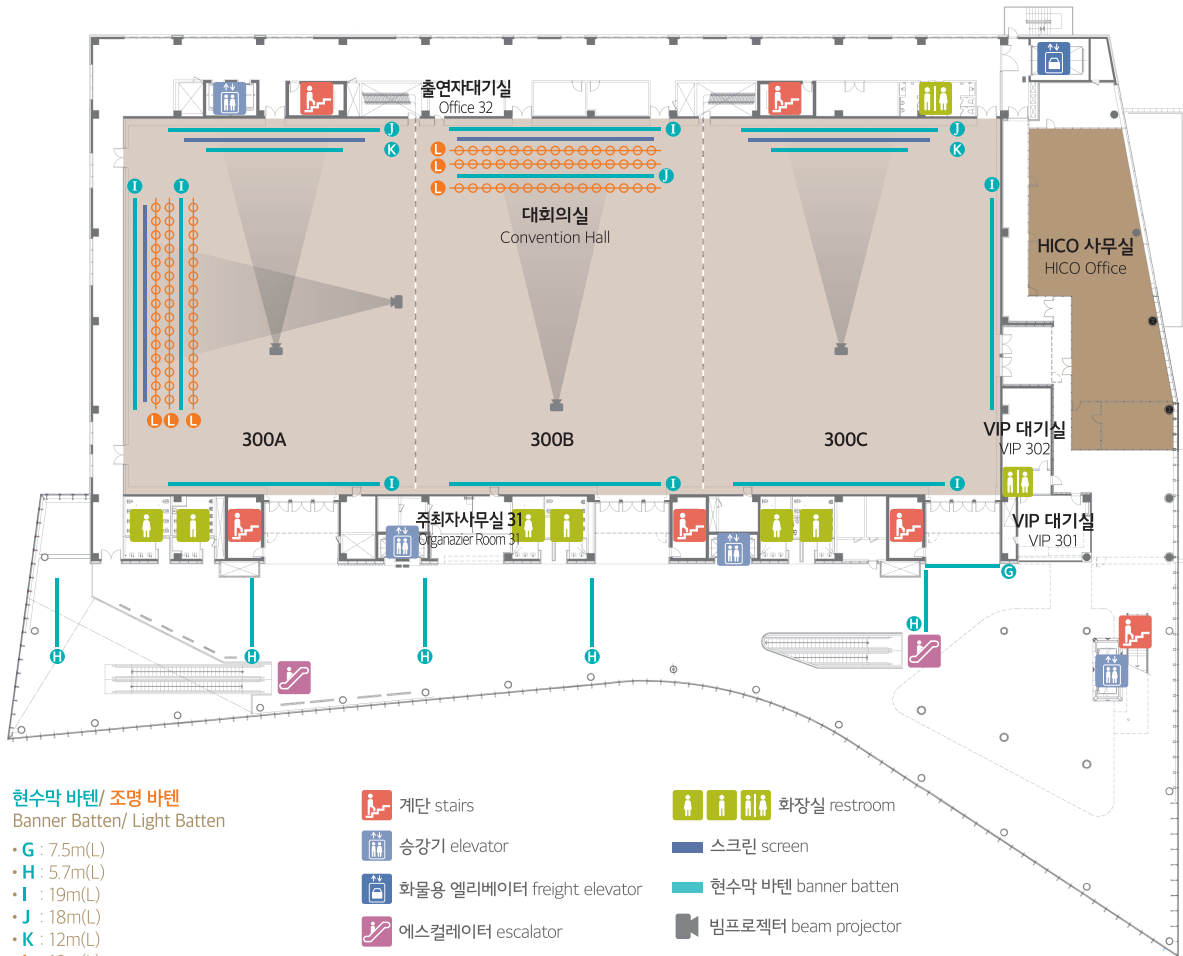

현수막 바텐/ 조명 바텐
Banner Batten/ Light Batten

- G : 7.5m(L)
- H : 5.7m(L)
- I : 19m(L)
- J : 18m(L)
- K : 12m(L)
- L : 19m(L)

계단 stairs

승강기 elevator

화물용 엘리베이터 freight elevator

에스컬레이터 escalator

화장실 restroom

스크린 screen

현수막 바텐 banner batten

빔프로젝터 beam projector

회의실 빔프로젝터/ 스크린

Beam Projector/ Screen in the Meeting Rooms

- Main 20,000ANSI/ 600"
- Sub 16,000ANSI/ 500"

※ VAT 10% 별도

구분 Facility	면적 Area (m ²)	가로x세로x높이 LxWxH (m)			극장식 Theater	강의실 Class- room	연회식 Banquet	임대료(원) Rental Rates (Unit: KRW, VAT not included)					
								09:00 -12:00	13:00 -17:00	18:00 -21:00	09:00 -17:00	13:00 -21:00	09:00 -21:00
								오전 Morning	오후 Afternoon	저녁 Evening	전일 Full Day	반일 Half Day	종일(1일) All Day
300A, 300B, 300C	1,140	29.5	38.4	12.5	1,150	600	500	2,851,000	3,421,000	2,566,000	5,702,000	6,272,000	8,552,000
300A+B, 300B+C	2,280	59.3	38.4	12.5	2,300	1,200	1,000	5,702,000	6,842,000	5,132,000	11,404,000	12,544,000	17,104,000
300A+B+C	3,421	89.1	38.4	12.5	3,500	1,800	1,600	8,553,000	10,263,000	7,698,000	17,106,000	18,816,000	25,656,000

바닥하중 Floor Load	0.5 ton/m ²	바닥마감재 Floor Finishing Material	타일 카펫 Tile Carpet
-----------------	------------------------	--------------------------------	-------------------

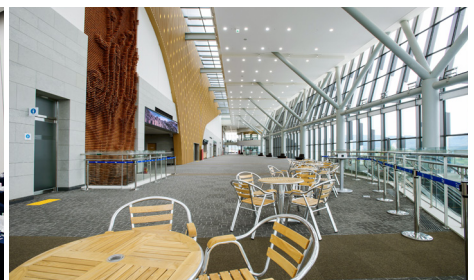

4F·B1

OTHER FACILITIES

부대시설

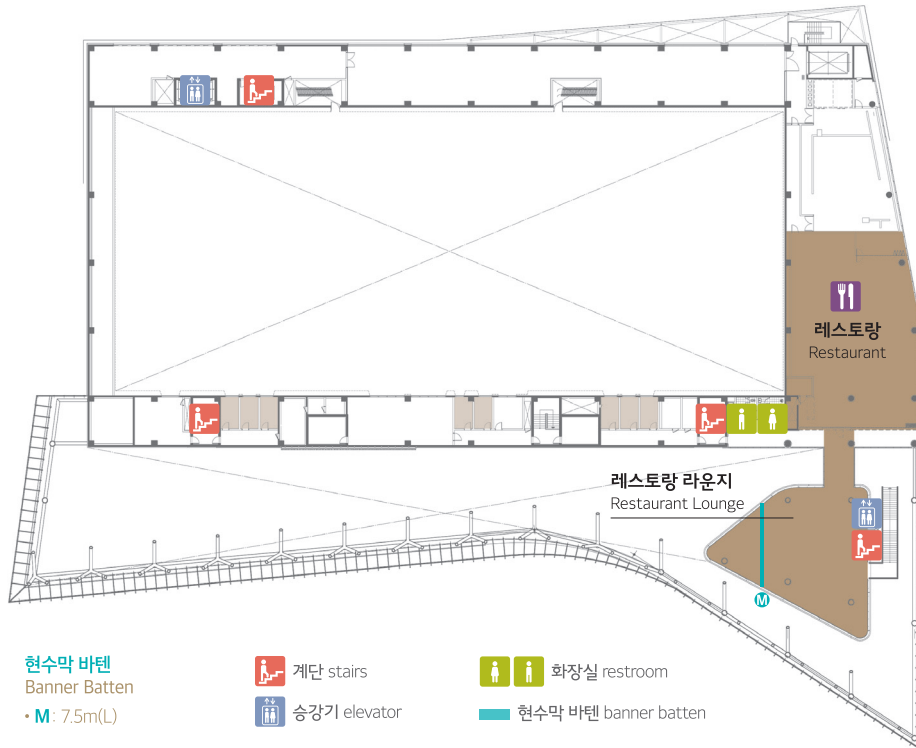

4F

레스토랑 Restaurant

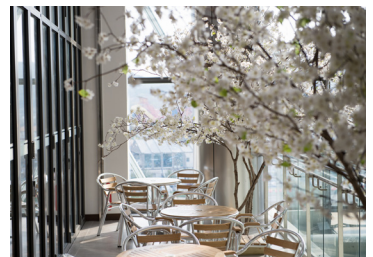

B1

하이코 플라자 HICO Plaza



10 • 경주화백컨벤션센터

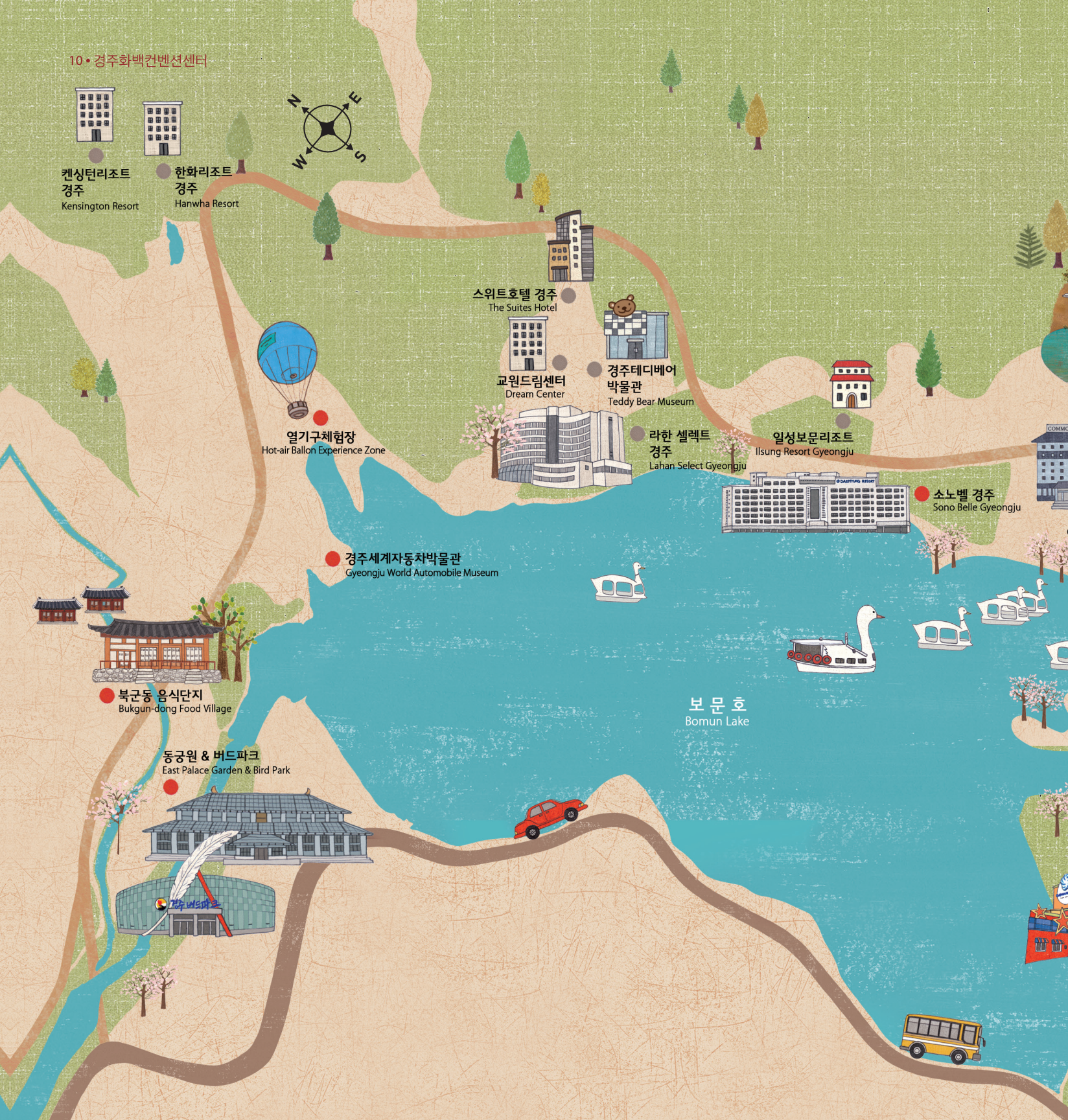

Accommodations 숙박

구분 Category	객실수 Room Qty	거리 (HICO기준) Distance (from HICO)
특급호텔 5-star Hotel		
라한 셀렉트 경주 Lahan Select Gyeongju	440	1.9km
힐튼 경주 Hilton Gyeongju	330	0.2km
코오롱호텔 Kolon Hotel	317	7.6km
The-K호텔경주 The-K Hotel Gyeongju	304	0.4km
코모도호텔 경주 Commodore Hotel Gyeongju	276	0.8km
관광호텔 Tourist Hotel		
스위스르젠호텔 BENIKEA Swiss Rosen Hotel Gyeongju	60	0.3km
경주 지지 관광호텔 Gyeongju Tourist Hotel GG	53	10.3km
스위트호텔 경주 The Suites Hotel Gyeongju	34	2.1km
전통 Korea Traditional Hotel		
라궁 Ragung(Millennium Palace)	16	0.8km

구분 Category	객실수 Room Qty	거리 (HICO기준) Distance (from HICO)
콘도 Condominium		
켄싱턴리조트 경주보문 Kensington Resort Gyeongju	526	3.5km
소노벨 경주 Sono Belle Gyeongju	417	1.0km
한화리조트 경주 Hanwha Resort Gyeongju	394	3.6km
블루원리조트 BlueOne Resort	205	2.1km
마우나오션리조트 Mauna Ocean Resort	127	31.2km
성호리조트 Sungho Resort Gyeongju	132	9.8km
일성보문리조트 Ilsung Resort Gyeongju	116	1.4km
기업연수원 Corporate Training Institute		
농협경주교육원 Nonghyup Cooperative Banking Training Gyeongju Institute	139	0.5km
드림센터연수원 Dream Center Gyeongju	104	2.2km
KT경주수련관 KT Gyeongju Refresher Center	57	0.2km
황룡원 Hwangnyongwon	34	0.4km

Access to Gyeongju 교통안내

고속철도 KTX, SRT (High-speed Railroad)

서울역 ↔ 신경주역 (120분)
Seoul Station ↔ Singyeongju Station (120 min.)

수서역 ↔ 신경주역 (120분)
Suseo Station ↔ Singyeongju Station (120 min.)

공항리무진버스 Airport Limousine

인천국제공항 ↔ 경주시외버스터미널 (270분)
Incheon Int'l Airport ↔ Gyeongju Intercity Bus Terminal (270 min.)

김해국제공항 ↔ 경주고속버스터미널 (70분)
Gimhae Int'l Airport ↔ Gyeongju Express Bus Terminal (70 min.)



물레방아 광장
Waterwheel Square

코모도호텔
Commodore Hotel

육부촌
Gyeongbuk
Tourism Organization

농협경주교육원
Nonghyup Cooperative Banking
Training Gyeongju Institute

보문정
Bomun Pagoda

베니키아
스위스로제호텔
Swiss Rosen Hotel

더케이호텔 경주
The-K Hotel

힐튼 경주
Hilton Gyeongju

하이코
HICO

KT 경주수련관
KT Gyeongju Refresher Center

라궁
Ragung (Millennium Palace)

신라밀레니엄파크
Shilla Millennium Park

황룡원
Hwangryongwon

경주월드 & 캘리포니아비치
Gyeongju World & California Beach

경주세계문화
엑스포공원
Gyeongju World Culture EXPO Park

블루원리조트 & 워터파크
BlueOne Resort & Water Park

38116 경상북도 경주시 보문로 507
507, Bomun-ro, Gyeongju, Gyeongsangbuk-do 38116, Rep. of Korea
Tel. (054) 702-1000 Fax. (054) 702-1029
www.hico.or.kr

